

**TD33/V.90  
TD-33**

**westermo®**

# INSTALLATION MANUAL

6179-2201

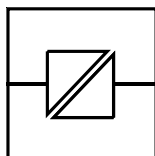

Galvanic  
Isolation

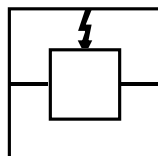

Transient  
Protection

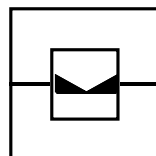

Balanced  
Transmission

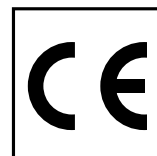

CE  
Approved

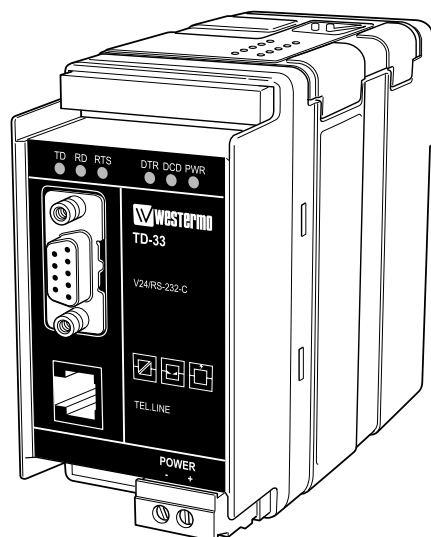

**Tele Modem  
V.90/K56flex™ or V.34**

**westermo®**  
[www.westermo.se](http://www.westermo.se)



## Table of Contents

Introduction .....	4
Safety .....	4
Specifications .....	5
Installation .....	6
RS-232/V.24 Connections .....	6
Line Connection .....	6
Typical TD-33 Line Connections .....	6
DIP Switch Setup .....	7
LED Status Indicators .....	7
AT Commands .....	8–20
Result Codes .....	21–23
S-Registers .....	24–31
Glossary .....	32–34

## Introduction

Congratulations for purchasing TD-33, probably the most robust modem device available on the market. You have just got a high quality product, and with the excellent support from Westermo you will certainly not be unsatisfied with this product.

The Westermo TD-33 is an industrialised dial-up line modem. This modem has been developed to be used in industrial applications and has some features one would not expect to find on a normal modem. Terminal data rates of up to 230.4 kbit/s can be handled using data compression and error correction. The maximum line modulation speed is 56.0 kbit/s (TD-33/V.90 ) or 33.6 kbit/s (TD-33 ).

A watchdog facility continually monitors the power supply and internal hardware. In the event of a problem the modem automatically resets. This feature has been included to make the unit more suitable for use in unmanned locations.

The TD-33 is available in two standard versions TD-33/V.90 including V.90 support and TD-33 containing up to V.34 support. The TD-33 is supplied by 12–36VDC.

The TD-33 has been designed with the engineer in mind, hence the extensive information on the command set, S registers, DIP switches and error codes.

We have endeavoured to include all necessary information however if you need more please do not hesitate to call us.

## Safety

TD-33 EU and TD-33/V.90 EU comply with TBR-21.

The TD-33 shall only be connected to a power supply or type SELV.

*Description of the above classifications are given in EN60950:1992*

The TD-33 complies with EN-500081-1 & EN-500082-1

## Specifications

<b>Modulation</b>	ITU-T V.90 28.0 up to 56.0 kbit/s K56flex™, 32.0 up to 56.0 kbit/s ITU-T V.34, 2.4 up to 33.6 kbit/s ITU-T V.32bis, 4.8 up to 14.4 kbit/s ITU-T V.32, 4 800/9 600 bit/s ITU-T v.23, 1 200 bit/s ITU-T V.22bis, 2 400 bit/s ITU-T V.22, Bell 212A, 1 200 bit/s ITU-T V.21, Bell 103, 300 bit/s
<b>Dial up</b>	Tone signals DTMF
<b>Settings</b>	AT-commands & switches
<b>Transmission</b>	Asynchronous
<b>Transmission speed, DTE</b>	300, 600, 1 200, 2 400, 4 800, 7 200, 9 600, 12.0k, 14.4k, 16.8k, 19.2k, 21.6k, 24.0k, 26.4k, 28.8k, 38.4k, 57.6k, 115.2k & 230.4k bit/s
<b>Compression</b>	V.42bis & MNP5
<b>Characters</b>	Up to 11 bits
<b>Error correction</b>	V.42 LAPM, MNP 2-4 & MNP 10
<b>Interface</b>	EIA RS-232-C/V.24
<b>Line interface</b>	RJ11
<b>Line</b>	2-wire for dial up connections
<b>Power supply</b>	12–36V DC
<b>Power consumption</b>	1.7 W at 12 V DC
<b>Isolation</b>	Between line and rest of electronics 1500V
<b>Fuse</b>	DC 1.0A
<b>Temperature</b>	0 to 60°C surrounding temperature
<b>Humidity</b>	0–95% RH, without condensation
<b>Dimensions</b>	55x100x128 mm (WxHxD)
<b>Weight</b>	0.2 kg
<b>Indications</b>	TD, RD, DCD, DTR, RTS and PWR
<b>Mounting</b>	On 35 mm DIN-rail
<b>Misc.</b>	Loudspeaker, DTR Hotcall

## Installation

The modem should be connected in the following way:

Power connection is made through screw-block at bottom right corner. It is a 2-pole connector for 12–36 V DC supply.

Computers or other equipment are connected through an 9-pole D-sub RS-232/V.24 connection. Do not use ribbon cable for RS-232 connections.

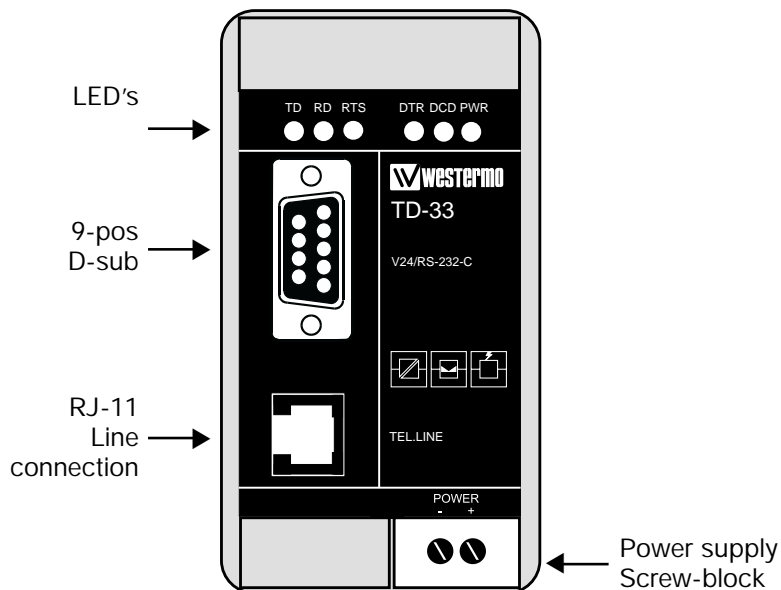

## RS-232/V.24 Connections

Pin outs for the 9-pole D-sub:

9-pos. D-sub	Direction DCE-DTE	Name	Description
1	→	DCD	Data carrier detect
2	→	RXD	Receive data
3	←	TXD	Transmit data
4	←	DTR	Data terminal ready
5	- - -	SG	Signal ground
6	→	DSR	Data Set Ready
7	←	RTS	Request to send
8	→	CTS	Clear to send
9	→	RI	Ring indicator

## Line connection

The telephone line is connected to the 2-pole RJ-11 connector. 2-wire lines are connected to the two middle pins (3 & 4) in the RJ-11 plug.

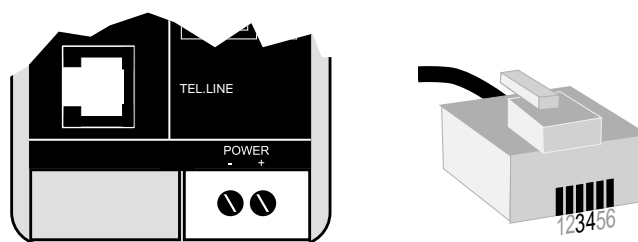

## Typical TD-33 line connections

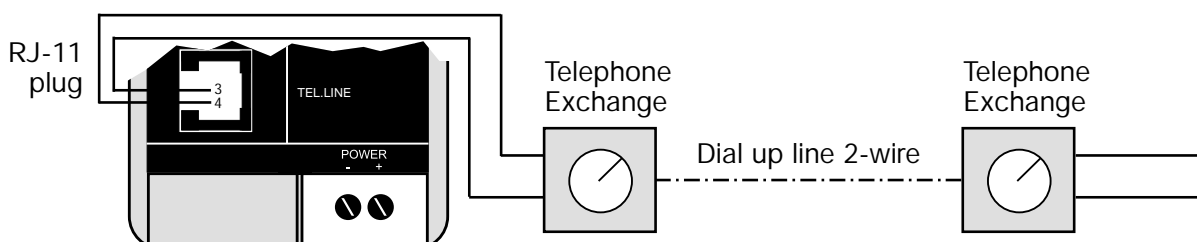

# DIP Switch Setup for Dial-up

Disconnect power before changing DIP-switches.  
Use ESD-protection when changing switches.

The DIP-switches can be used to provide the following settings.  
The DIP-Switches are underneath the top lid of the modem.  
Non defined switches will be in off position.

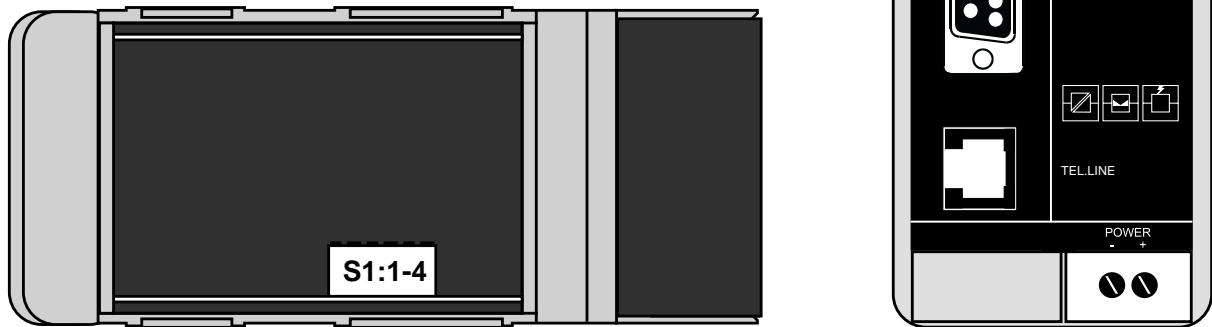

Switch I		Related AT-commands
	Software Watchdog Enable	
	PLC Mode (9 600 bit/s)	ATQ1E0&C1&K0
	DTR Hotcall Enable (9 600 bit/s)	ATDS=0
	Ignore DTE Characters	

Factory Settings

## LED Status Indicators

PWR	Power Indication. Flashes if an error is detected
DTR	Data Terminal Ready modem signal
RTS	Request To Send modem signal
TD	Transmitted Data: Displays data received from the local RS-232/V.24 port
RD	Received Data: Displays data leaving the modem on the RS-232/V.24 port
DCD	Data Carrier Detect modem signal

## AT Commands

### A – Answer

The modem will go off-hook and attempt to answer an incoming call if correct conditions are met. Upon successful completion of answer handshake, the modem will go on-line in answer mode.

The modem will enter the connect state after exchanging carrier with the remote modem. If no carrier is detected within a period specified in register S7, the modem hangs up. Any character entered during the connect sequence will abort the connection attempt.

### Bn – ITU-T or Bell

When the modem is configured to allow either option, the modem will select Bell or CCITT modulation for a line speed connection of 300 or 1200 bps according to the parameter supplied. Any other line speed will use a CCITT modulation standard. The parameter value, if valid, is written to S27 bit 6.

B0 Selects CCITT operation at 300 or 1200 bps during Call Establishment and a subsequent connection. **(Default)**

B1 Selects BELL operation at 300 or 1200 bps during Call Establishment and a subsequent connection.

### \Bn – Transmit Break to Remote

In non-error correction mode, the modem will transmit a break signal to the remote modem with a length in multiples of 100 ms according to parameter specified.

If a number in excess of 9 is entered, 9 is used. The command works in conjunction with the \K command. In error correction mode, the modem will signal a break through the active error correction protocol, giving no indication of the length.

\B1-\B9 Break length in 100 ms units. **(Default = 3.)** (Non-error corrected mode only.)

### &Cn – RLSD (DCD) Option

The modem controls the RLSD output in accordance with the parameter supplied.

The parameter value, if valid, is written to S21 bit 5.

&C0 RLSD remains ON at all times.

&C1 RLSD follows the state of the carrier. **(Default)**

### %C – Enable/Disable Data Compression

Enables or disables data compression negotiation. The modem can only perform data compression on an error corrected link.

The parameter value, if valid, is written to S41 bits 0 and 1.

%C0 Disables data compression. Resets S46 bit 1.

%C1 Enables MNP 5 data compression negotiation. Resets S46 bit 1.

%C2 Enables V.42 bis data compression. Sets S46 bit 1.

%C3 Enables both V.42 bis and MNP 5 data compression. Sets S46 bit 1. **(Default)**



## Dn – Dial

This command directs the modem to go on-line, dial according to the string entered and attempt to establish a connection. If no dial string is supplied, the modem will go on-line and attempt the handshake in originate mode.

### NOTE:

If the ATD command is issued before the S1 register has cleared, the modem will respond with the NO CARRIER result code.

The modem will behave as a data modem and will attempt to connect to another data modem. The modem will have up to the period of time specified by register S6 to wait for carrier and complete the handshake. If this time expires before the modem can complete the handshake, the modem will go on-hook with the NO CARRIER response. This command will be aborted in progress upon receipt of any DTE character before completion of the handshake.

### Dial Modifiers

The valid dial string parameters are described below. Punctuation characters may be used for clarity, with parentheses, hyphen, and spaces being ignored.

The valid dial string parameters are described below. Punctuation characters may be used for clarity, with parentheses, hyphen, and spaces being ignored.

- 0-9       DTMF digits 0 to 9.
- \*         The 'star' digit (tone dialing only).
- #         The 'gate' digit (tone dialing only).
- A-D       DTMF digits A, B, C, and D. Some countries may prohibit sending of these digits during dialing.
- L         Re-dial last number: the modem will re-dial the last valid telephone number. The L must be immediately after the D with all the following characters ignored).
- R         This command will be accepted, but not acted on.
- S=n       Dial the number stored in the directory (n = 0 to 3). (See &Z.)
- !         Flash: the modem will go on-hook for a time defined by the value of S29.
- W         Wait for dial tone: the modem will wait for dial tone before dialing the digits following "W". If dial tone is not detected within the time specified by S6 (EU), the modem will abort the rest of the sequence, return on-hook, and generate an error message.
- @         Wait for silence: the modem will wait for at least 5 seconds of silence in the call progress frequency band before continuing with the next dial string parameter. If the modem does not detect these 5 seconds of silence before the expiration of the call abort timer (S7), the modem will terminate the call attempt with a NO ANSWER message. If busy detection is enabled, the modem may terminate the call with the BUSY result code. If answer tone arrives during execution of this parameter, the modem handshakes.
- &         Wait for credit card dialing tone before continuing with the dial string. If the tone is not detected within the time specified by S6 (EU models), the modem will abort the rest of the sequence, return on-hook, and generate an error message.

- , Dial pause: the modem will pause for a time specified by S8 before dialing the digits following ",".
- ; Return to command state. Added to the end of a dial string, this causes the modem to return to the command state after it processes the portion of the dial string preceding the ",". This allows the user to issue additional AT commands while remaining off-hook. The additional AT commands may be placed in the original command line following the "," and/or may be entered on subsequent command lines. The modem will enter call progress only after an additional dial command is issued without the "," terminator. Use "H" to abort the dial in progress, and go back on-hook.
- ^ Toggles calling tone enable/disable: applicable to current dial attempt only.
- () Ignored: may be used to format the dial string.
- Ignored: may be used to format the dial string.
- <space> Ignored: may be used to format the dial string.
- <i> Invalid character: will be ignored.

## &Dn – DTR Option

This command interprets the ON to OFF transition of the DTR signal from the DTE in accordance with the parameter supplied. The parameter value, if valid, is written to S21 bits 3 and 4. Also, see S25.

&D0, DTR drop is interpreted according to the current &Qn setting as follows: &Q0, &Q5, &Q6 DTR is ignored (assumed ON). Allows operation with DTEs which do not provide DTR. &Q1 DTR drop causes the modem to hang up. Auto-answer is not affected. &Q2, &Q3 DTR drop causes the modem to hang up. Auto-answer is inhibited.

&D1 DTR drop is interpreted according to the current &Qn setting as follows: &Q0, &Q1, &Q5, &Q6 DTR drop is interpreted by the modem as if the asynchronous escape sequence had been entered. The modem returns to asynchronous command state without disconnecting. &Q2, &Q3 DTR drop causes the modem to hang up. Auto-answer is inhibited.

&D2 DTR drop is interpreted according to the current &Qn setting as follows: &Q0 through &Q6 DTR drop causes the modem to hang up. Auto-answer is inhibited. **(Default)**

&D3 DTR drop is interpreted according to the current &Qn setting as follows: &Q0, &Q1, &Q5, &Q6 DTR drop causes the modem to perform a soft reset as if the Z command were received. The &Y setting determines which profile is loaded. &Q2, &Q3 DTR drop causes the modem to hang up. Auto-answer is inhibited.

## En – Command Echo

The modem enables or disables the echo of characters to the DTE according to the parameter supplied. The parameter value, if valid, is written to S14 bit 1.

E0 Disables command echo.

E1 Enables command echo. **(Default)**

## **%En – Enable/Disable Line Quality Monitor and Auto-Retrain or Fallback/Fall Forward**

Controls whether or not the modem will automatically monitor the line quality and request a retrain (%E1) or fall back when line quality is insufficient or fall forward when line quality is sufficient (%E2). The parameter value, if valid, is written to S41 bits 2 and 6.

If enabled, the modem attempts to retrain for a maximum of 30 seconds.

%E0 Disable line quality monitor and auto-retrain.

%E1 Enable line quality monitor and auto-retrain.

%E2 Enable line quality monitor and fallback/fall forward. **(Default)**

Fallback/Fall Forward. When %E2 is active, the modem monitors the line quality (EQM). When line quality is insufficient, the modem will initiate a rate renegotiation to a lower speed within the V.34/V.32 bis/V.32 (TD-33) modulation speeds. The modem will keep falling back within the current modulation if necessary until the speed reaches 2 400 bit/s (V.34) or 4 800 bit/s (V.32). Below this rate, the modem will only do retrains if EQM thresholds are exceeded. If the EQM is sufficient for at least one minute, the modem will initiate a rate renegotiation to a higher speed within the current modulation speeds. The rate renegotiations will be done without a retrain if a V.32 bis connection is established. Speeds attempted during fallback/fall forward are those shown to be available in the rate sequences exchanged during the initial connection. Fallback/fall forward is available in error correction and normal modes, but not in direct mode.

## **&Fn – Restore Factory Configuration (Profile)**

The modem loads the factory default configuration (profile). The factory defaults are identified for each command and in the S-Register descriptions. A configuration (profile) consists of a subset of S-Registers.

&F0 Restore factory configuration 0.

&F1 Restore factory configuration 1.

## **&Gn – Select Guard Tone**

The modem generates the guard tone selected by this command according to the parameter supplied (DPSK modulation modes only). The parameter value, if valid, is written to S23 bits 6 and 7.

&G0 Disables guard tone. **(Default)**.

&G1 Disables guard tone.

&G2 Selects 1 800 Hz guard tone.

This command may not be permitted in some countries.

## Hn – Disconnect (Hang-Up)

This command initiates a hang up sequence.

H0 The modem will release the line if the modem is currently on-line. Country specific, modulation specific, and error correction protocol specific (S38) processing is handled outside of the H0 command.

H1 If on-hook, the modem will go off-hook and enter command mode. For EU models, the modem will return on-hook after a period of time determined by S7.

## \Kn – Break Control

Controls the response of the modem to a break received from the DTE or the remote modem or the \B command according to the parameter supplied. The parameter value, if valid, is written to S40 bits 3, 4, and 5.

The response is different in three separate states.

The first state is where the modem receives a break from the DTE when the modem is operating in data transfer mode:

\K0 Enter on-line command mode, no break sent to the remote modem.

\K1 Clear data buffers and send break to remote modem.

\K2 Same as 0.

\K3 Send break to remote modem immediately.

\K4 Same as 0.

\K5 Send break to remote modem in sequence with transmitted data. **(Default)**

The second case is where the modem is in the on-line command state

(waiting for AT commands) during a data connection,

and the \B is received in order to send a break to the remote modem:

\K0 Clear data buffers and send break to remote modem.

\K1 Clear data buffers and send break to remote modem. (Same as 0.)

\K2 Send break to remote modem immediately.

\K3 Send break to remote modem immediately. (Same as 2.)

\K4 Send break to remote modem in sequence with data.

\K5 Send break to remote modem in sequence with data. (Same as 4.) **(Default)**

The third case is where a break is received from a remote modem during a non-error corrected connection:

\K0 Clears data buffers and sends break to the DTE.

\K1 Clears data buffers and sends break to the DTE. (Same as 0.)

\K2 Send a break immediately to DTE.

\K3 Send a break immediately to DTE. (Same as 2.)

\K4 Send a break in sequence with received data to DTE.

\K5 Send a break in sequence with received data to DTE. (Same as 4.) **(Default)**

## &K – Flow Control

Defines the DTE/DCE Flow Control. The parameter is written to S39 bits 0,1, and 2.

&K0 Disables flow control **(Default)**.

&K3 Enables RTS/CTS.

&K4 Enables XON/XOFF.

&K5 Enables transparent XON/XOFF.

## **-Kn – MNP Extended Services**

Enables or disables conversion of a V.42 LAPM connection to an MNP 10 connection.

The parameter value, if valid, is written to S40 bits 0 and 1.

-K0 Disables V.42 LAPM to MNP 10 conversion. **(Default)**

-K1 Enables V.42 LAPM to MNP 10 conversion.

-K2 Enables V.42 LAPM to MNP 10 conversion; inhibits MNP Extended Services initiation during V.42 LAPM answer mode detection phase.

## **%L – Report Line Signal Level**

Returns a value which indicates the received signal level. The value returned is a direct indication of the receive level at the MDP, not at the telephone line connector. For example, 009 = -9 dBm, 043 = -43 dBm, and so on.

## **L – Speaker Volume**

Sets the speaker volume control. The parameter is written to S22 bits 0 and 1.

L0 Low Volume

L1 Low Volume **(Default)**

L2 Medium Volume.

L3 High Volume.

## **M – Speaker Control**

Speaker Control command. The parameter is written to S22 bits 2 and 3.

M0 Speaker is always off

M1 Speaker is on during call establishment, but off when receiving a carrier. **(Default)**

M2 Speaker is always on.

M3 Speaker is off when receiving a carrier and during dialing, but on during answering.

## **+MS – Select Modulation**

This extended-format command selects the modulation and, optionally, enables or disables automode, specifies the lowest and highest receive rates, and, specifies the highest transmit rate using one to six subparameters. The command format is:

+MS=<carrier>,<automode>,<min\_tx\_rate>,<max\_tx\_rate>,<min\_rx\_rate>,<max\_rx\_rate>

Where

<carrier> = A string which specifies the preferred modulation (automode enabled) or the modulation (automode disabled) to use in originating or answering a connection. The options are:

<carrier> Modulation Possible Rates (bit/s)

V21 V.21 300

V22 V.22 1 200

V22B V.22 bis 2 400 or 1 200

V23C V.23 1 200

V32 V.32 9 600 or 4 800

V32B V.32 bis 14 400, 12 000, 9 600, 7 200, or 4 800

V34 V.34 33 600, 31 200, 28 800, 26 400, 24 000, 21 600, 19 200, 16 800, 14 400, 12 000, 9 600, 7 200, 4 800, or 2 400

V90 V.90 56 000, 54 667, 53 333, 52 000, 50 667, 49 333, 48 000, 46 667, 45 333,  
42 667, 41 333, 40 000, 38 667, 37 333, 36 000, 34 667, 33 333, 32 000, 30 667,  
29 333, 28 000  
B103 Bell 103 300  
B212 Bell 212 1 200

<automode>

0 disable

1 enable

<min\_xx\_rate>, <max\_xx\_rate>

Min and max data rates depending on modulation used (see below).

### Reporting Supported Options

The modem can send a string of information to the DTE consisting of supported options using the following command:

+MS=?

or

For listing current configuration:

+MS?

## \Nn – Operating Mode

This command controls the preferred error correcting mode to be negotiated in a subsequent data connection.

\N0 Selects normal speed buffered mode (disables error-correction mode). (Forces &Q6.)

\N1 Serial interface selected – Selects direct mode and is equivalent to &Q0 mode of operation. (Forces &Q0.)

\N2 Selects reliable (error-correction) mode. The modem will first attempt a LAPM connection and then an MNP connection. Failure to make a reliable connection results in the modem hanging up. (Forces &Q5, S36=4, and S48=7.)

\N3 Selects auto reliable mode. This operates the same as \N2 except failure to make a reliable connection results in the modem falling back to the speed buffered normal mode. (Forces &Q5, S36=7, and S48=7.)

\N4 Selects LAPM error-correction mode. Failure to make an LAPM error-correction connection results in the modem hanging up. (Forces &Q5 and S48=0.) Note: The -K1 command can override the \N4 command.

\N5 Selects MNP error-correction mode. Failure to make an MNP error-correction connection results in the modem hanging up. (Forces &Q5, S36=4, and S48=128.)

## On – Return to On-Line Data Mode

This command determines how the modem will enter the on-line data mode. If the modem is in the on-line command mode, it enters the on-line data mode with or without a retrain. If the modem is in the off-line command mode (no connection), ERROR is reported.

O0 Enters on-line data mode without a retrain. Handling is determined by the Call Establishment task. Generally, if a connection exists, this command connects the DTE back to the remote modem after an escape (+++).

O1 Enters on-line data mode with a retrain before returning to on-line data mode.

## **Qn – Quiet Results Codes Control**

The command enables or disables the sending of result codes to the DTE according to the parameter supplied. The parameter value, if valid, is written to S14 bit 2.

Q0 Enables result codes to the DTE. **(Default)**

Q1 Disables result codes to the DTE.

## **%Q – Report Line Signal Quality**

Reports the line signal quality. Returns the higher order byte of the EQM value. Based on the EQM value, retrain or fallback/fall forward may be initiated if enabled by %E1 or %E2.

## **&Sn – DSR Override**

This command selects how the modem will control DSR. The parameter value, if valid, is written to S21 bit 6.

&S0 DSR will remain ON at all times. **(Default)**

&S1 DSR will become active after answer tone has been detected and inactive after the carrier has been lost.

## **%Un – Select $\mu$ -Law or A-Law Codec Type**

This command selects  $\mu$ -Law or A-Law codec type for V.90 and K56flex modulation.

This command also stores the selected setting directly to NVRAM.

%U0 Selects  $\mu$ -Law.

%U1 Selects A-Law.

## **Vn – Result Code Form**

This command selects the sending of short-form or long-form result codes to the DTE.

The parameter, if valid, is written to S14 bit 3.

V0 Enables short-form (terse) result codes. Line feed is not issued before a short-form result code.

V1 Enables long-form (verbose) result codes. **(Default)**

## **&Q – Async Mode**

This command is used to control the connection modes permitted. It is used in conjunction with S36 and S48. (Also, see \N).

&Q0 Selects direct asynchronous operation. The value 000b is written to S27 bits 3, 1, and 0, respectively. See &M0.

&Q5 The modem will try to negotiate an error-corrected link. The modem can be configured using S36 to determine whether a failure will result in the modem returning on hook or will result in fallback to an asynchronous connection. The value 101b is written to S27 bits 3, 1 and 0 respectively (Default).

&Q6 Selects asynchronous operation in normal mode (speed buffering). The value 110b is written to S27 bits 3, 1 and 0, respectively.

## **\Vn – Single Line Connect Message Enable**

This command enables or disables the single line connect message format as follows:

\V0 Connect messages are controlled by the command settings X, W, and S95.

\V1 Connect messages are displayed in the single line format described below subject to the command settings V (Verbose) and Q (Quiet). In Non-Verbose mode (V0), single line connect messages are disabled and a single numeric result code is generated for CONNECT DTE.

When single line connect messages are enabled, there are no CARRIER, PROTOCOL, or COMPRESSION messages apart from the fields described below.

The single line connect message format is:

```
CONNECT <DTE Speed></Modulation></Protocol></Compression></Line  
Speed>/<Voice and Data>
```

Where:

<DTE Speed> = DTE speed, e.g., 57 600.

Modulation = "V90" for V.90 modulation.

"K56" for K56flex modulation.

"V34" for V.34 modulation.

"V32" for V.32 or V.32bis modulation.

Note: Modulation is omitted for all other modulations.

Protocol = "NONE" for no protocol.

"ALT" for Microcom Network Protocol.

"LAPM" for LAP-M protocol.

Compression = "CLASS5" for Microcom MNP5 compression.

"V42BIS" for V.42bis compression.

Note: Compression is omitted if protocol is NONE.

Line Speed = Asymmetric rates are displayed as /rate:TX/rate:RX, e.g., /1 200 TX/75 RX.

Symmetric rates are displayed as a single DCE rate, e.g., 14 400.

Voice and Data = Blank for Data mode only.

LAPM-SREJ = Selective reject.



## **&V – Display Current Configuration and Stored Profiles**

&V - Display Current Configuration and Stored Profiles Reports the current (active) configuration, the stored (user) profiles, and the first four stored telephone numbers. The stored profiles and telephone numbers are not displayed if the NVRAM is not operational as detected by the NVRAM test during reset processing.

Example:

AT&V

ACTIVE PROFILE:

B0 E1 L1 M1 N1 QO T V1 W0 X4 Y0 &C0 &D0 &G2 &K3 &Q5 &R1 &S0 &T4  
&X0 &Y0 S00:002 S01:000 S02:043 S03:013 S04:010 S05:008 S06:002 S07:030  
S08:002 S09:006 S10:014 S11:255 S12:050 S18:000 S25:005 S26:001 S36:007  
S37:000 S38:020 S46:138 S48:007 S95:000

STORED PROFILE 0:

B0 E1 L1 M1 N1 QO T V1 W0 X4 Y0 &C0 &D0 &G2 &K3 &Q5 &R1 &S0 &T4  
&X0 S00:002 S02:043 S06:002 S07:030 S08:002 S09:006 S10:014 S11:095 S12:050  
S18:000 S36:007 S37:000 S40:105 S41:003 S46:138 S95:000

STORED PROFILE 1:

B0 E1 L1 M1 N1 QO T V1 W0 X4 Y0 &C0 &D0 &G2 &K3 &Q5 &R1 &S0 &T4  
&X0 S00:002 S02:043 S06:002 S07:030 S08:002 S09:006 S10:014 S11:095 S12:050  
S18:000 S36:007 S37:000 S40:105 S41:003 S46:138 S95:000

TELEPHONE NUMBERS:

0 = 1 =

2 = 3 =

OK

## &VI – Display Last Connection Statistics

Displays the last connection statistics in the following format (shown with typical results):

TERMINATION REASON..... LOCAL REQUEST

LAST TX rate..... 26 400 BIT/S

HIGHEST TX rate..... 26 400 BIT/S

LAST RX rate..... 46 667 BIT/S

HIGHEST RX rate..... 46 667 BIT/S

PROTOCOL..... LAPM

COMPRESSION..... V42Bis

Line QUALITY..... 033

Rx LEVEL..... 015

Highest Rx State..... 67

Highest TX State..... 67

EQM Sum..... 00C2

RBS Pattern..... FF

Rate Drop..... FF

Digital Pad..... None

Local Rtrn Count..... 00

Remote Rtrn Count..... 00

Flex 9481814347C4

RBS Pattern: Shows the number of least significant bits robbed per 6 bytes.

Digital Pad: Shows if a pad was encountered and if so, what was the digital loss.

Flex: Shows V.8bis information as follows:

First byte: Octet 13 (second byte of manufacturer id, 94 = K56flex)

Second byte: Octet 14 (Licensee code: 81 = Rockwell)

Third byte: Octet 15 (manufacturer's product capabilities)

Fourth byte: Octet 16 (K56flex version number)

Fifth byte: Octet 17 (Rockwell pump code version number)

Sixth byte: Octet 18 (x-law and controller version number)

Bit 6 Forced/Not forced A-Law/ $\mu$ -Law

0 = Forced A-Law/ $\mu$ -Law

1 = Not forced A-Law/ $\mu$ -Law

Bit 5 Select A-Law or  $\mu$ -Law

0 = Select A-Law

1 = Select  $\mu$ -Law

Bit 4:0 Controller version

## Wn – Connect Message Control

This command controls the format of CONNECT messages. The parameter value, if valid, is written to S31 bits 2 and 3.

W0 Upon connection, the modem reports only the DTE speed (e.g., CONNECT 19 200). Subsequent responses are disabled.

W1 Upon connection, the modem reports the line speed, the error correction protocol, and the DTE speed, respectively. Subsequent responses are disabled. **(Default)**

W2 Upon connection, the modem reports the DCE speed (e.g., CONNECT 14 400). Subsequent responses are disabled.

## &Wn – Store Current Configuration

Saves the current (active) configuration (profile), including S-Registers, in one of the two user profiles in NVRAM as denoted by the parameter value. This command will yield an ERROR message if the NVRAM is not operational as detected by the NVRAM test.

The current configuration is comprised of a list of storable parameters illustrated in the &V command. These settings are restored to the active configuration upon receiving an Zn command or at power up (see &Yn command).

&W0 Store the current configuration as profile 0.

&W1 Store the current configuration as profile 1.

## Xn – Extended Result Codes

This command selects which subset of the result messages will be used by the modem to inform the DTE of the results of commands.

Blind dialing is enabled or disabled by country parameters. If the user wishes to enforce dial tone detection, a "W" can be placed in the dial string (see D command). Note that the information below is based upon the default implementation of the X results table.

X0 Disables monitoring of busy tones unless forced otherwise by country requirements; send only OK, CONNECT, RING, NO CARRIER, ERROR, and NO ANSWER result codes. Blind dialing is enabled/disabled by country parameters. If busy tone detection is enforced and busy tone is detected, NO CARRIER will be reported. If dial tone detection is enforced or selected and dial tone is not detected, NO CARRIER will be reported instead of NO DIAL TONE. The value 000b is written to S22 bits 6, 5, and 4, respectively.

X1 Disables monitoring of busy tones unless forced otherwise by country requirements; send only OK, CONNECT, RING, NO CARRIER, ERROR, NO ANSWER, and CONNECT XXXX (XXXX = rate). Blind dialing enabled/disabled by country parameters. If busy tone detection is enforced and busy tone is detected, NO CARRIER will be reported instead of BUSY. If dial tone detection is enforced or selected and dial tone is not detected, NO CARRIER will be reported instead of NO DIAL TONE. The value 100b is written to S22 bits 6, 5, and 4, respectively.

X2 Disables monitoring of busy tones unless forced otherwise by country requirements; send only OK, CONNECT, RING, NO CARRIER, ERROR, NO DIALTONE, NO ANSWER, and CONNECT XXXX. If busy tone detection is enforced and busy tone is detected, NO CARRIER will be reported instead of BUSY. If dial tone detection is enforced or selected and dial tone is not detected, NO DIAL TONE will be reported instead of NO CARRIER. The value 101b is written to S22 bits 6, 5, and 4, respectively.

X3 Enables monitoring of busy tones; send only OK, CONNECT, RING, NO CARRIER, ERROR, NO ANSWER, and CONNECT XXXX. Blind dialing is enabled/disabled by country parameters. If dial tone detection is enforced and dial tone is not detected, NO CARRIER will be reported. The value 110b is written to S22 bits 6, 5, and 4, respectively.

X4 Enables monitoring of busy tones; send all messages. The value 111b is written to S22 bits 6, 5, and 4, respectively. **(Default)**

## **Yn – Long Space Disconnect**

This command enables/disables the generation and response to long space disconnect. The parameter value, if valid, is written to S21 bit 7.

Y0 Disables long space disconnect. **(Default)**

Y1 Enables long space disconnect. In non-error correction mode, the modem will send a long space of four seconds prior to going on-hook. In non-error correction mode, the modem will respond to the receipt of a long space (i.e., a break signal greater than 1.6 seconds) by going on-hook.

## **&Yn – Designate a Default Reset Profile**

This command selects which user profile will be used after a hard reset.

&Y0 The modem will use profile 0.

&Y1 The modem will use profile 1.

## **Zn – Soft Reset and Restore Profile**

The modem performs a soft reset and restores (recalls) the configuration profile according to the parameter supplied. If no parameter is specified, zero is assumed.

Z0 Soft reset and restore stored profile 0.

Z1 Soft reset and restore stored profile 1.

## **&Zn=x – Store Telephone Number**

The modem can store up to four telephone numbers and each telephone number dial string can contain up to 34 digits.

&Zn=x n = 0 to 3 and x = dial string.

## Result Codes

- 0 OK A command line has been executed.
- 1 CONNECT For X command values specifying no speed reporting, the modem has connected to the line and either the line speed is 300 bit/s and line speed is enabled, or the DTE speed is 300 bit/s and DTE speed reporting is enabled.
- 2 RING An incoming ring signal is detected on the line.
- 3 NO CARRIER Sent when attempting to establish a call if:
  - 1. Ringback is detected and later ceases but no carrier is detected within the period of time determined by register S7, or
  - 2. No ringback is detected within the period of time determined by register S7.Also sent when the modem auto-disconnects due to loss of carrier.  
For X0, sent for the following conditions:
  - 1. If busy tone detection is enforced, busy or circuit busy has been detected.
  - 2. If dial tone detection is enforced or selected, dial tone has not been detected.
- 4 ERROR Sent during an attempt to execute a command line if any of the following conditions occur:
  - 1. The command line contains a syntax error.
  - 2. The modem cannot execute a command contained in the command line, i.e., the command does not exist or is not supported.
  - 3. A command parameter within the command line is outside the permitted range.For X0, X1, X2, and X3, this message is sent instead of DELAYED and BLACKLISTED.
- 5 CONNECT 1 200 The modem has connected to the line and either the line speed is 1 200 bit/s and DCE speed reporting is enabled, or the DTE speed is 1 200 bit/s and DTE speed reporting is enabled.
- 6 NO DIALTONE For X2 and X4, the modem has been instructed to wait for dial tone during dialing but none is received.
- 7 BUSY For X3 and X4, if busy tone detection is enforced, the busy (engaged) signal is detected on the line when the modem is attempting to originate a call.
- 8 NO ANSWER The modem is attempting to originate a call if a continuous ringback signal is detected on the line until the expiration of the timer S7.
- 9 CONNECT 0600 The modem has connected to the line, the DTE speed is 600 bit/s, and DTE speed reporting is enabled.
- 10 CONNECT 2 400 The modem has connected to the line and either the line speed is 2 400 bit/s and DCE speed reporting is enabled, or the DTE speed is 2 400 bit/s and DTE speed reporting is enabled.
- 11 CONNECT 4 800 The modem has connected to the line and either the line speed is 4 800 bit/s and DCE speed reporting is enabled, or the DTE speed is 4 800 bit/s and DTE speed reporting is enabled.
- 12 CONNECT 9 600 The modem has connected to the line and either the line speed is 9 600 bit/s and DCE speed reporting is enabled, or the DTE speed is 9 600 bit/s and DTE speed reporting is enabled.
- 13 CONNECT 7 200 The modem has connected to the line at 7 200 bit/s and DCE speed reporting is enabled.
- 14 CONNECT 12 000 The modem has connected to the line at 12 000 bit/s and DCE speed reporting is enabled.
- 15 CONNECT 14 400 The modem has connected to the line at 14 400 bit/s and DCE speed reporting is enabled.
- 16 CONNECT 19 200 The modem has connected to the line and either the line speed is 19 200 bit/s and DCE speed reporting is enabled, or the DTE speed is 19 200 bit/s and DTE speed reporting is enabled.
- 17 CONNECT 38 400 The modem has connected to the line, the DTE speed is 38 400 bit/s, and DTE speed reporting is enabled.
- 18 CONNECT 57 600 The modem has connected to the line, the DTE speed is 57 600 bit/s, and DTE speed reporting is enabled.
- 19 CONNECT 115 200 The modem has connected to the line, the DTE speed is 115 200 bit/s, and DTE speed reporting is enabled.
- 22 CONNECT  
75TX/1 200RX  
The modem has established a V.23 originate connection and line speed reporting is enabled.
- 23 CONNECT  
1 200TX/75RX  
The modem has established a V.23 answer connection and line speed reporting is enabled.
- 24 DELAYED For X4, sent when a call fails to connect and the number dialed is considered 'delayed' due to country blacklisting requirements.
- 32 BLACKLISTED For X4, sent when a call fails to connect and the number dialed is considered 'blacklisted'.
- 40 CARRIER 300 The modem has connected to the line at 0–300 bit/s and carrier reporting is enabled.  
(See S95 and Xn.)
- 44 CARRIER 1 200/75 The V.23 backward channel carrier is detected and carrier reporting is enabled.  
(See S95 and Xn.)
- 45 CARRIER 75/1 200 The V.23 forward channel carrier is detected and carrier reporting is enabled.  
(See S95 and Xn.)
- 46 CARRIER 1 200 The modem has connected to the line at 1200 bit/s and carrier reporting is enabled.  
(See S95 and Xn.)
- 47 CARRIER 2 400 The modem has connected to the line at 2400 bit/s and carrier reporting is enabled.  
(See S95 and Xn.)

- 48 CARRIER 4 800 The modem has connected to the line at 4 800 bit/s and carrier reporting is enabled.  
(See S95 and Xn.)
- 49 CARRIER 7 200 The modem has connected to the line at 7 200 bit/s and carrier reporting is enabled.  
(See S95 and Xn.)
- 50 CARRIER 9 600 The modem has connected to the line at 9 600 bit/s and carrier reporting is enabled.  
(See S95 and Xn.)
- 51 CARRIER 12 000 The modem has connected to the line at 12 000 bit/s and carrier reporting is enabled.  
(See S95 and Xn.)
- 52 CARRIER 14 400 The modem has connected to the line at 14 400 bit/s and carrier reporting is enabled.  
(See S95 and Xn.)
- 53 CARRIER 16 800 The modem has connected to the line at 16 800 bit/s and carrier reporting is enabled.  
(See S95 and Xn.)
- 54 CARRIER 19 200 The modem has connected to the line at 19 200 bit/s and carrier reporting is enabled.  
(See S95 and Xn.)
- 55 CARRIER 21 600 The modem has connected to the line at 21 600 bit/s and carrier reporting is enabled.  
(See S95 and Xn.)
- 56 CARRIER 24 000 The modem has connected to the line at 24 000 bit/s and carrier reporting is enabled.  
(See S95 and Xn.)
- 57 CARRIER 26 400 The modem has connected to the line at 26 400 bit/s and carrier reporting is enabled.  
(See S95 and Xn.)
- 58 CARRIER 28 800 The modem has connected to the line at 28 800 bit/s and carrier reporting is enabled.  
(See S95 and Xn.)
- 59 CONNECT 16 800 The modem has connected to the line, the DTE speed is 16 800 bit/s and DTE speed reporting is enabled.
- 61 CONNECT 21 600 The modem has connected to the line, the DTE speed is 21 600 bit/s and DTE speed reporting is enabled.
- 62 CONNECT 24 000 The modem has connected to the line, the DTE speed is 24 000 bit/s and DTE speed reporting is enabled.
- 63 CONNECT 26 400 The modem has connected to the line, the DTE speed is 26 400 bit/s and DTE speed reporting is enabled.
- 64 CONNECT 28 800 The modem has connected to the line and either the line speed is 28 800 bit/s and DCE speed reporting is enabled, or the DTE speed is 28 800 bit/s and DTE speed reporting is enabled.
- 66 COMPRESSION:  
CLASS 5  
The modem has connected to the line in MNP Class 5 and COMPRESSION message reporting is enabled.  
(See S95, Wn, and Xn.)
- 67 COMPRESSION:  
V.42 bis  
The modem has connected to the line in V.42 bis and COMPRESSION message reporting is enabled.  
(See S95, Wn, and Xn.)
- 69 COMPRESSION:  
NONE  
The modem has connected to the line without data compression and COMPRESSION message reporting is enabled. (See S95, Wn, and Xn.)
- 70 PROTOCOL: NONE The modem has connected to the line without any form of error correction and the PROTOCOL message reporting has been enabled.  
(See S95, Wn, and Xn.)
- 77 PROTOCOL: LAPM The modem has connected to the line in V.42 LAPM error correction mode and PROTOCOL message reporting has been enabled.  
(See S95, Wn, and Xn.)
- 78 CARRIER 31 200 The modem has connected to the line at 31 200 bit/s and carrier reporting is enabled.  
(See S95 and Xn.)
- 79 CARRIER 33 600 The modem has connected to the line at 33 600 bit/s and carrier reporting is enabled.  
(See S95 and Xn.)
- 80 PROTOCOL: ALT Sent when the modem has connected in the MNP mode of error correction, and PROTOCOL message reporting has been enabled.  
(See S95, Wn, and Xn.)
- 84 CONNECT 33 600 The modem has connected to the line, the DTE speed is 33 600 bit/s and the DTE speed reporting is enabled.
- 91 CONNECT 31 200 The modem has connected to the line DTE speed is 31 200 bit/s and the modem is to report the DTE speed upon connecting.
- 150 CARRIER 32 000 The modem has connected to the line at 32 000 bit/s and carrier reporting is enabled.  
(See S95 and Xn.)
- 151 CARRIER 34 000 The modem has connected to the line at 34 000 bit/s and carrier reporting is enabled.  
(See S95 and Xn.)
- 152 CARRIER 36 000 The modem has connected to the line at 36 000 bit/s and carrier reporting is enabled.  
(See S95 and Xn.)

- 153 CARRIER 38 000 The modem has connected to the line at 38 000 bit/s and carrier reporting is enabled.  
(See S95 and Xn.)
- 154 CARRIER 40 000 The modem has connected to the line at 40 000 bit/s and carrier reporting is enabled.  
(See S95 and Xn.)
- 155 CARRIER 42 000 The modem has connected to the line at 42 000 bit/s and carrier reporting is enabled.  
(See S95 and Xn.)
- 156 CARRIER 44 000 The modem has connected to the line at 44 000 bit/s and carrier reporting is enabled.  
(See S95 and Xn.)
- 157 CARRIER 46 000 The modem has connected to the line at 46 000 bit/s and carrier reporting is enabled.  
(See S95 and Xn.)
- 158 CARRIER 48 000 The modem has connected to the line at 48 000 bit/s and carrier reporting is enabled.  
(See S95 and Xn.)
- 159 CARRIER 50 000 The modem has connected to the line at 50 000 bit/s and carrier reporting is enabled.  
(See S95 and Xn.)
- 160 CARRIER 52 000 The modem has connected to the line at 52 000 bit/s and carrier reporting is enabled.  
(See S95 and Xn.)
- 161 CARRIER 54 000 The modem has connected to the line at 54 000 bit/s and carrier reporting is enabled.  
(See S95 and Xn.)
- 162 CARRIER 56 000 The modem has connected to the line at 56 000 bit/s and carrier reporting is enabled.  
(See S95 and Xn.)
- 165 CONNECT 32 000 The modem has connected to the line at 32 000 bit/s and DCE speed reporting is enabled.
- 166 CONNECT 34 000 The modem has connected to the line at 34 000 bit/s and DCE speed reporting is enabled.
- 167 CONNECT 36 000 The modem has connected to the line at 36 000 bit/s and DCE speed reporting is enabled.
- 168 CONNECT 38 000 The modem has connected to the line at 38 000 bit/s and DCE speed reporting is enabled.
- 169 CONNECT 40 000 The modem has connected to the line at 40 000 bit/s and DCE speed reporting is enabled.
- 170 CONNECT 42 000 The modem has connected to the line at 42 000 bit/s and DCE speed reporting is enabled.
- 171 CONNECT 44 000 The modem has connected to the line at 44 000 bit/s and DCE speed reporting is enabled.
- 172 CONNECT 46 000 The modem has connected to the line at 46 000 bit/s and DCE speed reporting is enabled.
- 173 CONNECT 48 000 The modem has connected to the line at 48 000 bit/s and DCE speed reporting is enabled.
- 174 CONNECT 50 000 The modem has connected to the line at 50 000 bit/s and DCE speed reporting is enabled.
- 175 CONNECT 52 000 The modem has connected to the line at 52 000 bit/s and DCE speed reporting is enabled.
- 176 CONNECT 54 000 The modem has connected to the line at 54 000 bit/s and DCE speed reporting is enabled.
- 177 CONNECT 56 000 The modem has connected to the line at 56 000 bit/s and DCE speed reporting is enabled.
- 178 CONNECT 230 400 The modem has connected to the line, the DTE speed is 230 400 bit/s, and DTE speed reporting is enabled.
- 180 CONNECT 28 000 The modem has connected to the line at 28 000 bit/s and DCE reporting is enabled.
- 181 CONNECT 29 333 The modem has connected to the line at 29 333 bit/s and DCE reporting is enabled.
- 182 CONNECT 30 667 The modem has connected to the line at 30 667 bit/s and DCE reporting is enabled.
- 183 CONNECT 33 333 The modem has connected to the line at 33 333 bit/s and DCE reporting is enabled.
- 184 CONNECT 34 667 The modem has connected to the line at 34 667 bit/s and DCE reporting is enabled.
- 185 CONNECT 37 333 The modem has connected to the line at 37 333 bit/s and DCE reporting is enabled.
- 186 CONNECT 38 667 The modem has connected to the line at 38 667 bit/s and DCE reporting is enabled.
- 187 CONNECT 41 333 The modem has connected to the line at 41 333 bit/s and DCE reporting is enabled.
- 188 CONNECT 42 667 The modem has connected to the line at 42 667 bit/s and DCE reporting is enabled.
- 189 CONNECT 45 333 The modem has connected to the line at 45 333 bit/s and DCE reporting is enabled.
- 190 CONNECT 46 667 The modem has connected to the line at 46 667 bit/s and DCE reporting is enabled.
- 191 CONNECT 49 333 The modem has connected to the line at 49 333 bit/s and DCE reporting is enabled.
- 192 CONNECT 50 667 The modem has connected to the line at 50 667 bit/s and DCE reporting is enabled.
- 193 CONNECT 53 333 The modem has connected to the line at 53 333 bit/s and DCE reporting is enabled.
- 194 CONNECT 54 667 The modem has connected to the line at 54 667 bit/s and DCE reporting is enabled.

## S-registers

### S0 – Number of Rings to Auto-Answer

S0 sets the number of the rings required before the modem automatically answers a call.

Setting this register to zero disables auto-answer mode.

Range: 0–255 rings

**Default: 2**

### S1 – Ring Counter

S1 is incremented each time the modem detects a ring signal on the telephone line.

S1 is cleared if no rings occur over an eight second interval.

Range: 0–255 rings

**Default: 0**

### S2 – Escape Character

S2 holds the decimal value of the ASCII character used as the escape character.

The **default** value corresponds to an ASCII '+'. A value over 127 disables the escape process, i.e., no escape character will be recognized.

Range: 0–255, ASCII decimal

**Default: 43 (+)**

### S3 – Carriage Return Character

S3 sets the command line and result code terminator character.

Range: 0–127, ASCII decimal

**Default: 13 (Carriage Return)**

### S4 – Line Feed Character

S4 sets the character recognized as a line feed. The Line Feed control character is output after the Carriage Return control character if verbose result codes are used.

Range: 0–127, ASCII decimal

**Default: 10 (Line Feed)**

### S5 – Backspace Character

S5 sets the character recognized as a backspace. The modem will not recognize the Backspace character if it is set to a value that is greater than 32 ASCII. This character can be used to edit a command line. When the echo command is enabled, the modem echoes back to the local DTE the Backspace character, an ASCII space character and a second Backspace character; this means a total of three characters are transmitted each time the modem processes the Backspace character.

Range: 0–32, ASCII decimal

**Default: 8 (Backspace)**



### **S6 – Wait Time before Blind Dialing or for Dial Tone**

Sets the length of time, in seconds, that the modem will wait for dial tone when encountering a “W” dial modifier before returning NO DIAL TONE result code.

(EU models)

The modem always pauses for a minimum of 2 seconds, even if the value of S6 is less than 2 seconds.

Range: 2–60 seconds

**Default: 4**

### **S7 – Wait Time for Carrier, Silence, or Dial Tone**

S7 operation is country dependent.

1. Sets the length of time, in seconds, that the modem will wait for carrier before hanging up. The timer is started when the modem finishes dialing (originate), or 2 seconds after going off-hook (answer). In originate mode, the timer is reset upon detection of answer tone if allowed by country restrictions.
2. Sets the length of time, in seconds, that modem will wait for silence when encountering the @ dial modifier before continuing with the next dial string parameter.

Range: 1–255 seconds

**Default: 50**

### **S8 – Pause Time For Dial Delay**

S8 sets the time, in seconds, that the modem must pause when the “,” dial modifier is encountered in the dial string.

Range: 0–255 seconds

**Default: 2**

### **S9 – Carrier Detect Response Time**

S9 is supported for backwards compatibility only. No value can be written. Responds with default value.

Range: 6 tenths of a second

**Default: 6 (0.6 second)**

### **S10 – Lost Carrier To Hang Up Delay**

S10 sets the length of time, in tenths of a second, that the modem waits before hanging up after a loss of carrier. This allows for a temporary carrier loss without causing the local modem to disconnect. When register S10 is set to 255, the modem functions as if a carrier is always present. The actual interval the modem waits before disconnecting is the value in register S10 minus the value in register S9.

Therefore, the S10 value must be greater than the S9 value or else the modem disconnects before it recognizes the carrier.

Range: 1–255 tenths of a second

**Default: 14** (1.4 seconds)

### **S11 – DTMF Tone Duration**

S11 operation is country dependent.

Range: 50–255 milliseconds

**Default: 95** (95 milliseconds)

### **S12 – Escape Prompt Delay (EPD)**

S12 defines the maximum period, in fiftieths of a second, allowed between receipt of the last character of the three escape character sequence from the DTE and sending of the OK result code to the DTE. If any characters are detected during this time, the OK will not be sent. Note that sending of the OK result code does not affect entry into command mode.

Range: 0–255 1/50 of a second

**Default: 50** (1 second)

### **S14 – General Bit Mapped Options Status**

S14 indicates the status of command options.

**Default: 138** (8Ah) (10001010b)

Bit 0 This bit is ignored.

Bit 1 Command echo (En)

0 = Disabled (E0)

1 = Enabled (E1) (**Default**)

Bit 2 Quiet mode (Qn)

0 = Send result codes (Q0) (**Default**)

1 = Do not send result codes (Q1)

Bit 3 Result codes (Vn)

0 = Numeric (V0)

1 = Verbose (V1) (**Default**)

Bit 4 Reserved

Bit 5 Tone (T)

0 = Tone (T) (**Default**)

Bit 6 Reserved

Bit 7 Originate/Answer

0 = Answer

1 = Originate (**Default**)

## **S21 – V.24/General Bit Mapped Options Status**

S21 indicates the status of command options.

**Default: 52 (34h) (00110100b)**

Bit 0 Reserved (0)

Bit 1 Reserved (0)

Bit 2 CTS behavior (&Rn)

0 = CTS tracks RTS (&R0)

1 = CTS always on (&R1) **(Default)**

Bits 3–4 DTR behavior (&Dn)

0 = &D0 selected

1 = &D1 selected

2 = &D2 selected **(Default)**

3 = &D3 selected

Bit 5 RLSD (DCD) behavior (&Cn)

0 = &C0 selected

1 = &C1 selected **(Default)**

Bit 6 DSR behavior (&Sn)

0 = &S0 selected **(Default)**

1 = &S1 selected

Bit 7 Long space disconnect (Yn)

0 = Y0 **(Default)**

1 = Y1

## **S22 Speaker/Results Bit Mapped Options Status**

S22 indicates the status of commands options.

**Default: 117 (75h) (01110101b)**

Bits 0–1 Speaker volume (Ln)

0 = Off(L0)

1 = Low(L1) **(Default)**

2 = Medium(L2)

3=High(L3)

Bits 2–3 Speaker Control (Mn)

0 = Disabled (M0)

1 = Off on carrier (M1) **(Default)**

2 = Always on (M2)

3= On during handshake

Bits 4-6 Limit result codes (Xn)

0 = X0

4 = X1

5 = X2

6 = X3

7 = X4 **(Default)**

Bit7 Reserved

### **S24 – Sleep Inactivity Timer**

S24 sets the length of time, in seconds, that the modem will operate in normal mode with no detected telephone line or DTE line activity before entering low-power sleep mode. The timer is reset upon any DTE line or telephone line activity. If the S24 value is zero, neither DTE line nor telephone inactivity will cause the modem to enter the sleep mode.

Range: 0–255 seconds

**Default: 0**

### **S25 – Delay To DTR**

S25 sets the length of time that the modem will ignore DTR for taking the action specified by &Dn. Its units are one hundredths of a second for other modes.

Range: 0–255 (0.01 seconds)

**Default: 5** (0.05 seconds)

### **S29 – Flash Dial Modifier Time**

S29 sets the length of time, in units of 10 ms, that the modem will go on-hook when it encounters the flash (!) dial modifier in the dial string. The time can be limited as it is a country dependent parameter.

Range: 0–255 10 ms intervals

**Default: 0** (0 ms)

### **S30 – Disconnect Inactivity Timer**

S30 sets the length of time, in tens of seconds, that the modem will stay online before disconnecting when no data is sent or received. In error-correction mode, any data transmitted or received will reset the timer. In other modes, any data transmitted will reset the timer.

Range: 0–255 tens of seconds (0–2 550 seconds)

**Default: 0** (disabled)

### **S31 – Bit Mapped Options Status**

S31 indicates bit mapped options status.

Bit 0 Single line connect message enable/disable (\Vn)

0 = Messages controlled by S95, Wn and Vn (\V0) (**Default**)

1 = Single line connect message (\V1)

Bit 1 Auto line speed detection (Nn)

0 = Disabled (N0)

1 = Enabled (N1) (**Default**)

Bits 2–3 Error correction progress messages (Wn)

0 = DTE speed only (W0)

1 = Full reporting (W1) (**Default**)

2 = DCE (line) speed only (W2)

Bits 4–5 Caller ID (#CID)

0 = Caller ID disabled (#CID=0) (**Default**)

1 = Short (formatted) Caller ID enabled (#CID=1)

2 = Long (unformatted) Caller ID enabled (#CID=2)

Bits 6–7 Reserved (**Default** = 11b)

### **S36 – LAPM Failure Control**

**Default:** 7 (00000111b)

Bits 0–2 This value indicates what should happen upon a LAPM failure. These fallback options are initiated immediately upon connection if S48=128. If an invalid number is entered, the number is accepted into the register, but S36 will act as if the default value has been entered.

0 = Modem disconnects.

1 = Modem stays on-line and a Direct mode connection is established.

2 = Reserved.

3 = Modem stays on-line and a Normal mode connection is established.

4 = An MNP connection is attempted and if it fails, the modem disconnects.

5 = An MNP connection is attempted and if it fails, a Direct mode connection is established.

6 = Reserved.

7 = An MNP connection is attempted and if it fails, a Normal mode connection is established. **(Default)**

Bits 3–7 Reserved

### **S38 – Delay Before Forced Hang Up**

S38 specifies the delay between the modem's receipt of the H command to disconnect (or ON-to-OFF transition of DTR if the modem is programmed to follow the signal), and the disconnect operation. Applicable to error-correction connection only. This register can be used to ensure that data in the modem buffer is sent before the modem disconnects.

1. If S38 is set to a value between 0 and 254, the modem will wait that number of seconds for the remote modem to acknowledge all data in the modem buffer before disconnecting. If time expires before all data is sent, the NO CARRIER result code will be issued to indicate that data has been lost. If all data is transmitted prior to time-out, the response to the H0 command will be OK.
2. If S38 is set to 255, the modem does not time-out and continues to attempt to deliver data in the buffer until the connection is lost or the data is delivered.

Range: 0–255 seconds

**Default:** 20

### **S39 – Flow Control Bit Mapped Options Status**

**Default:** 0

Bits 0–2 Status of command options

0 = No flow control **(Default)**

3 = RTS/CTS

4 = XON/XOFF

5 = Transparent XON

Bits 3–7 Reserved

#### **S40 – General Bit Mapped Options Status**

S40 indicates the status of command options.

**Default: 104** (68h) (01101000b)

Bits 0–1 MNP Extended Services (-Kn)

0 = Disable extended services (-K0) (**Default**)

1 = Enable extended services (-K1)

2 = Enable extended services (-K2)

Bit 2 Reserved

Bits 3–5 Break Handling (\Kn)

0 = \K0

1 = \K1

2 = \K2

3 = \K3

4 = \K4

5 = \K5 (**Default**)

Bits 6–7 Reserved

#### **S41 – General Bit Mapped Options Status**

S41 indicates the status of command options.

**Default: 195** (C3h) (11000011b)

Bits 0–1 Compression selection (%Cn)

0 = Disabled (%C0)

1 = MNP 5 (%C1)

2 = V.42 bis (%C2)

3 = MNP 5 and V.42 bis (%C3) (**Default**)

Bits 2, 6 Auto retrain and fallback/fall forward (%En)

Bit 6 Bit 2

0 0 = Retrain and fallback/fall forward disabled (%E0)

0 1 = Retrain enabled (%E1)

1 0 = Fallback/fall forward enabled (%E2) (**Default**)

Bit 3 Reserved

Bits 4–5 Reserved

Bit 7 Reserved

#### **S46 – Data Compression Control**

S46 controls selection of compression. The following actions are executed for the given values:

Range: 136 or 138

**Default: 138**

S46=136 Execute error correction protocol with no compression.

S46=138 Execute error correction protocol with compression. (**Default**)

### **S48 – V.42 Negotiation Action**

The V.42 negotiation process determines the capabilities of the remote modem. However, when the capabilities of the remote modem are known and negotiation is unnecessary, this process can be bypassed if so desired.

Range: 0, 7, or 128 If an invalid number is entered, it is accepted into the S-Register, but S48 will act as if 128 has been entered.

#### **Default: 7**

S48=0 Disable negotiation; bypass the detection and negotiation phases; and proceed with LAPM.

S48=7 Enable negotiation. **(Default)**

S48=128 Disable negotiation; bypass the detection and negotiation phases; and proceed at once with the fallback action specified in S36. Can be used to force MNP.

### **S86 – Call Failure Reason Code**

When the modem issues a NO CARRIER result code, a value is written to this S-Register to help determine the reason for the failed connection. S86 records the first event that contributes to a NO CARRIER message. Range: 0–24, the cause codes are:

S86= 0 Normal disconnect, no error occurred.

S86= 4 Loss of carrier.

S86= 5 V.42 negotiation failed to detect an error-correction modem at the other end.

S86= 9 The modems could not find a common protocol.

S86=12 Normal disconnect initiated by the remote modem.

S86=13 Remote modem does not respond after 10 re-transmissions of the same message.

S86=14 Protocol violation.

### **S91 – PSTN Transmit Attenuation Level**

S91 sets the transmit attenuation level from –13 to 15 dBm for the PSTN mode, resulting in a transmit level from –13 to –15 dBm.

Range: 13 to 15 dBm (Corresponding to –13 to –15 dBm transmit level.)

**Default: 13** (–13 dBm transmit level.)

### **S95 – Extended Result Codes**

A bit set to a 1 in this register will enable the corresponding result code regardless of the W setting.

#### **Default: 0**

Bit 0 CONNECT result code indicates DCE speed instead of DTE speed.

Bit 1 Append/ARQ to CONNECT XXXX result code in error-correction mode (XXXX = rate).

Bit 2 Enable +MCR: XXXX result code (XXXX = rate).

Bit 3 Enable +ER: XXXX result code (XXXX = protocol identifier).

Bit 4 Reserved.

Bit 5 Enable +DR: result code (XXXX = compression type).

Bit 6 Reserved.

Bit 7 Reserved.

# Glossary

## ASCII

A binary code system which defines 128 characters using different combinations of 1s and 0s. ASCII = American Standard Code for Information Interchange.

## Asynchronous Data

Transmission where the characters are transmitted one at a time, starting with a start bit and ending with a stop bit. About 90–95% of all serial data communications are asynchronous.

## Baud

The number of data symbols transmitted every second. Often baud = bit/s. Sometimes a few data symbols can represent several bits since different coding are used to compress data.

## Buffer

A memory for storing data for a short time, e.g. until the receiver is ready.

## Byte

A byte is a number of data bits (1s or 0s) which forms a character. Most often a character consists of 7 or 8 bits.

## DCE

Describes which direction the signals in the RS-232/V.24 contact have. Modems are often DCE. DCE = Data Communication Equipment.

## DIN rail

An installation rail which is used in apparatus cubicles to set up different equipment on a simple way. DIN = Deutsche Industri Norme.

## DTE

Same as DCE but the signals are directed on opposite directions. Terminals, PC's and printers are most often DTE. DTE = Data Terminal Equipment.

## Data Compression and Error Correction.

**V.42** ITU-T's error correction protocol incorporating LAPM. If the V.42 connection fails then usually MNP will be tried.

**LAPM** Link Access Procedure for Modems. An error correction method used in transmissions via PTT modems.

**MNP** Microcom Networking Protocol. Several methods for error correction and data compression for PTT modems.

MNP 1: Asynchronous Protocol, half duplex.

MNP 2: Asynchronous Protocol, full duplex, Data is divided into blocks (slower data rate).

MNP 3: Synchronous Protocol, full duplex. Data in blocks (higher speeds with no errors).

MNP 4: Similar to 3, but with smaller data blocks allowing for faster data rates with no errors.

MNP 5: Level 4 with data compression, gives about double the data rate.

MNP 10: Development of MNP5 with dynamic line monitoring and block size adjustment, used on very bad lines (cellular phone connections).

**ARQ** Automatic Repeat reQuest. When incorrect data is detected a request to retransmit the data is made to the remote modem.

**V.42bis.** Data Compression technique used by modems rather than MNP5, because it offers better transmission on already compressed data.



**Data Rate**

In modems this is often different to the baud rate. For instance the Data Rate of V.32bis is 14 400bit/s and the baud rate is 2 400 symbols/second.

**Direct Mode**

The Data to be transmitted is sent directly to the data pump (the modem circuit). No compression, error correction or buffering occurs, allowing the data to be transmitted across the link unaltered by the modem.

**Duplex**

Means that the communication is bi-directional. In half duplex, the devices take turns sending and receiving. In full duplex, sending and receiving can take place simultaneously.

**Hayes commands**

A set of commands for controlling PTT modems. Often referred to as the AT command set, since all commands are started with AT. Most modems support these commands, but there are variations and commands that are specific for a certain modem.

**ISP**

Internet Service Provider.

**LED**

Light-Emitting Diode. A semi-conductor which emits light when it receives an electrical current. In modems they are used as indicators for data and status signals.

**Modem**

Acronym of the words modulator and demodulator. Modulates or transforms the signal from computer equipment into electrical or acoustic signals for transmission. The receiver has a similar modem which retransforms the signal, demodulation.

Modem Modulation Standards

V.21	300 bit/s, similar to Bell 103
V.23	1 200/75 bit/s Split speed line
V.22	1 200 bit/s full duplex.
V.22bis	2 400 bit/s full duplex.
V.32	9 600 bit/s full duplex.
V.32bis	14 400 bit/s full duplex.
V.34	33 600 bit/s full duplex.
V.90/K56flex	Asymmetrical transmission standards 56kbit/s downstream data, 33.6kbit/s upstream data.

**Modulation Techniques****DPSK**

Differential Phase Shift Keying. Employed in data rates up to 4 800 bit/s.

**FSK**

Frequency Shift Keying. Used in the lowest data rate standards.

**QAM**

Quadrature Amplitude Modulation. A technique used for data rates up to 9 600 bit/s.

**TCM**

Trellis Coded Modulation. Used in the high speed modulations.

**PCM**

Pulse Coded Modulation. Used in the V.90 standard for downstream data from a digital end.

**NVRAM**

Non Volatile Random Access Memory. Consists most often by an EEPROM (Electronically Erasable and Programmable memory). Used by the modem to store profile information and numbers even when the unit has no power.

**Normal Mode**

A non error corrected connection, where data is buffered.

**Off Hook**

Like picking up the receiver. Connecting to a line.

**On Hook**

Like hanging up the receiver. Disconnecting.

**PSTN**

Public Switched Telephone Network, i.e. a normal telephone line on which other subscribers can be called.

**Parity**

A mathematically derived bit which is added by the transmitter. The receiver checks it to detect any error in transmission. Occurring parities are even, odd and none.

**REN Number**

The Ringer Equivalence Number (REN) is a way of measuring the load on the telephone line caused by the connected equipment.

**RS-232/V.24 Signals****TD**

Transmitted Data. Data going from DTE to DCE.

**RD**

Received Data. The Data going from DCE to DTE.

**RTS**

Request To Send from DTE.

**DSR**

Data Set Ready. The DCE-equipment is powered and usable.

**DTR**

Data Terminal Ready. The DTE-equipment is powered and usable.

**DCD**

Data Carrier Detect. A signal from the DCE indicating that a carrier is present on the line.

**Simplex**

Uni-directional communication.

**Start bit**

Marks the start of a character at asynchronous communication.

**Stop bit**

One or more stop bits marks the end of a character at asynchronous communication. Systems that require more than one stop bit may have problems during communication via modems, since modems most often remove the second stop bit.



# Block diagram

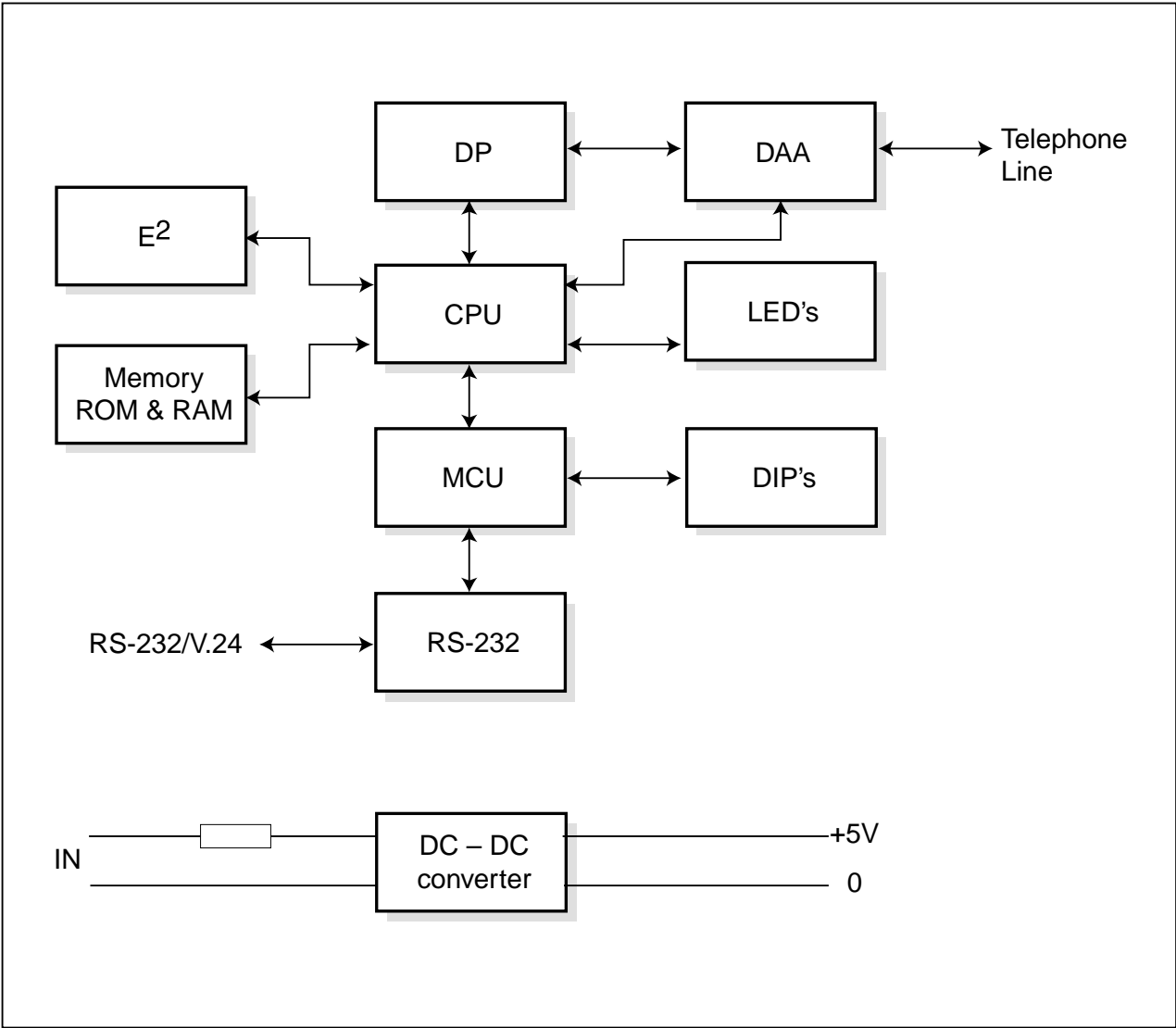

Westermo Teleindustri AB have distributors in several countries,  
contact us for further information.



Westermo Teleindustri AB • S-640 40 Stora Sundby, Sweden  
Phone +46 16 612 00 Fax +46 16 611 80  
E-mail: [info@westermo.se](mailto:info@westermo.se) • Westermo Web site: [www.westermo.se](http://www.westermo.se)

## Subsidiaries

Westermo Data Communications Ltd  
Unit 14 Talisman Business Centre • Duncan Road  
Park Gate, Southampton • SO31 7GA  
Phone: +44(0)1489 580 585 • Fax: +44(0)1489 580586  
E-Mail: [sales@westermo.co.uk](mailto:sales@westermo.co.uk) • Web: [www.westermo.co.uk](http://www.westermo.co.uk)

Westermo Data Communications GmbH  
Bruchsaler Straße 18, 68753 Waghäusel  
Tel.: +49(0)7254-95400-0 • Fax: +49(0)7254-95400-9  
E-Mail: [info@westermo.de](mailto:info@westermo.de) • Web: [www.westermo.de](http://www.westermo.de)